

## ALT BF73 system: Description

---

**ALT BF73** system of bi-folding panoramic doors is a modern exclusive solution designed for residential houses, as well as commercial buildings with café entrances and restaurant terraces, showrooms and meeting rooms in business centers and hotels.



## ALT BF73 system: Full-size mock-up



- Outward opening '4-3-1' door configuration
- Height: 2945 mm
- Width: 3090 mm
- Frame profiles used: BF73.0101 (bottom), BF73.0102 (top, side)
- Adjustable jamb: BF73.0501
- Sash profile: BF73.0201
- Sash weight: 70 kg
- Double glazing: 32 mm
- Multi-locking active sash
- DBLK-51 multipoint lock extension with DBLK-52 top shoot bolt
- DBLK-06 Robust heavy duty intermediate lock is used on the first and third passive sashes
- Handle with a semi-cylinder on the first passive sash, handle without a cylinder on the third passive sash

<b>Characteristics</b>	<b>Performances</b>	<b>Characteristics</b>	<b>Performances</b>
Acoustic performance	Up to 36 dB	Frame mounting depth	73 mm
Thermal insulation	1,4 – 1,7 W/m <sup>2</sup> *K	Sash mounting depth	73 mm
Air tightness	Class 4	Max. glazing thickness	44 mm
Water tightness	600 Pa (Class 9A)	Max. sash weight	120 kg
Burglar resistance	WK2, PAS24	Max. sash height	3000 mm
Max. door length	6500 mm	Max. sash width	1200 mm
(while using the frame connector)	(up to 16800 mm)		

## ALT BF73 system: Advantages

High burglar resistance is ensured by the glass bead profiles, installed from the inside of the room.

Double- and triple glazing : from 28 to 44 mm.



Thermal insulation parameter (U-value) varies from 1.4 ~1.7 [W/ (m<sup>2</sup>.K)] depending on the glazing unit selected.

\* The above mentioned advantages are relevant for a full-size mock-up.

## ALT BF73 system: Advantages

Powder coating is available in all RAL-colours, 9 colours of anodizing, **4 types** of surface treatment.

The central leaves are securely fixed by the intermediate lock operated by the "low" handles  
- do not prevent the door folding.

The usage of the hidden support rollers, hinges as well as the multi-locking elements allows to achieve high tightness characteristics.

BF73 system is certified in accordance with BS6375 part 1, PAS24 standard.

The usage of the adjustable jamb allows to compensate up to 8mm differences occurred while the door assembly and installation.

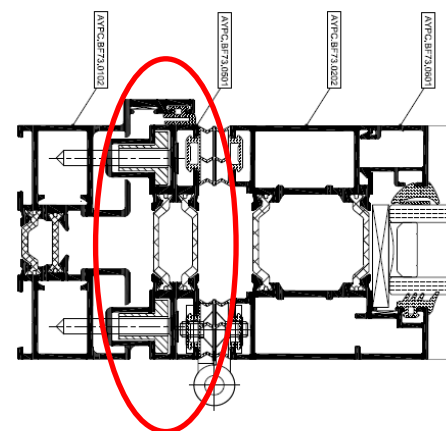
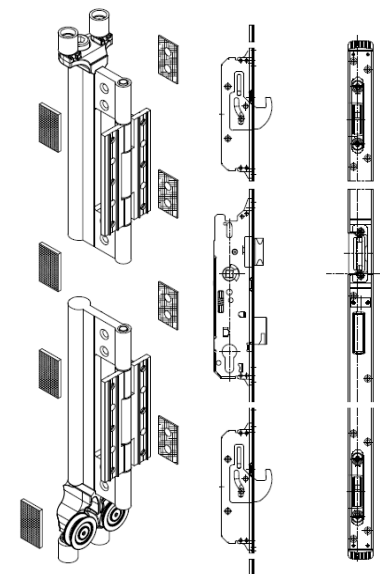

\* The above mentioned advantages are relevant for a full-size mock-up.